

Lakehall

AT



NENA'S

Sanctuary







Lakehall

at Nena's Sanctuary

The first phase in the development of Nena's Sanctuary is Lakehall. It is an event space that combines breathtaking lakeside, golf course, and garden views with modern, contemporary, and world-class amenities and luxuries. Located within the grounds of Sta. Elena Golf and Country Estate in Sta. Rosa Laguna, it features multiple and beautiful indoor and outdoor spaces, that work for all kinds of experiences and events.

Combining seemingly disparate and contrasting elements, such as – nature and modernity, destination and proximity, serendipity and careful attention to detail, it offers an inimitable, unified, and inspiring backdrop for your imagined activities, events, and special life celebrations.





Beyond Four Walls

Lakehall

It was envisioned to be a space that breaks free from the four walls - be it the constraints of the four walls of the city or the four walls that limit one's potential or creativity.



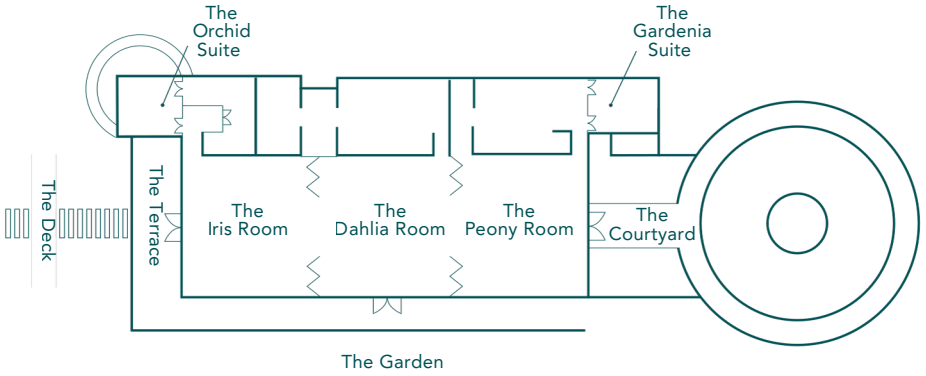



THE *Courtyard*

The Courtyard serves as the perfect drop-off point for guests. The entrance walkway is surrounded by carefully arranged potted plants and foliage, with wooded-floor patios on each side – offering a private, secluded spot to mingle and enjoy cocktails before the main event. This indoor-outdoor foyer can be used as a transition space for bigger weddings or parties, or on its own for more intimate gatherings.



THE *Banquet Hall*

The **Banquet Hall** captures the beauty of its natural surroundings with its contemporary yet warm design, featuring a wood-clad ceiling, concrete botanical walls, and modern drop lights. Glass sliding doors reveal gorgeous views of the lake and gardens. The entire space can hold up to 360 guests and can also be divided into three rooms for smaller events: The Peony Room, The Dahlia Room, and The Iris Room. Each space is equipped with its own service kitchen and set of restrooms.

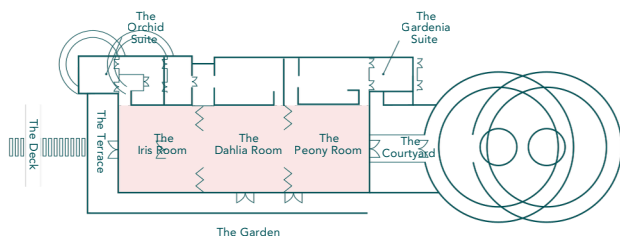



The Peony Room



The Dahlia Room

THE SEPARATE ROOMS

The Peony Room is the first space that guests walk into upon entering The Banquet Hall. It can fit up to 120 guests, has its own service kitchen and restrooms, and has access points from The Courtyard and The Garden. It also houses The Gardenia Suite, one of two private accommodations which can be booked for overnight stays.

The Dahlia Room is the central room of The Banquet Hall. It can fit up to 120 guests, has its own service kitchen and restrooms, and is adjacent to the gardens, where hosts can stage a lovely outdoor cocktail set-up.

The Iris Room occupies the corner-most area of The Banquet Hall, facing out onto The Terrace and The Deck.

It can fit up to 120 guests, has its own service kitchen and restrooms, and access points from The Garden and The Terrace. The Iris Room also houses The Orchid Suite, one of two private accommodations which can be booked for overnight stays. With views overlooking the lake, it is The Banquet Hall's most premium room.

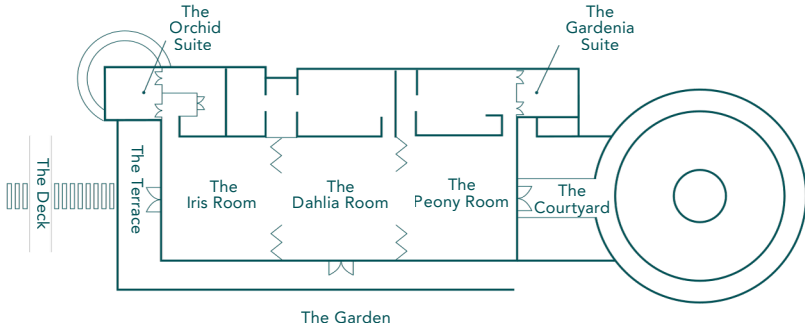

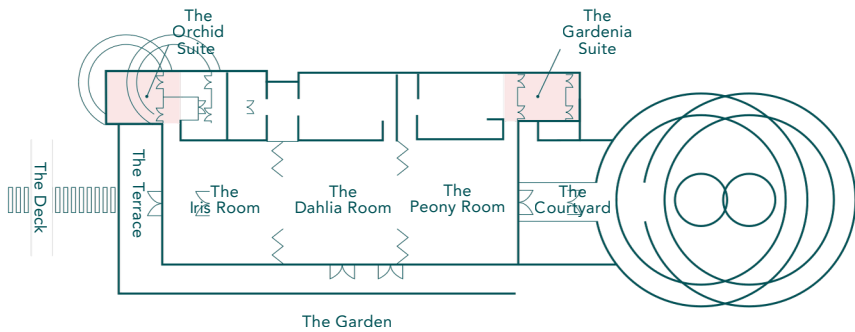

THE SUITES

The Orchid Suite is a luxurious private room with its own bedroom, lounge, bathroom, walk-in closet, and private gardens. Facing the lake and golf course, it makes the most beautiful spot to wake up to the sunrise and morning sounds of birdsong. The suite can be booked for overnight stays, which come with a free breakfast.

One of The Banquet Hall's luxurious getting-ready rooms, **The Gardenia Suite** is nestled in its own secluded area for maximum comfort and privacy. It has a bedroom with a queen-sized bed, lounge, bathroom, walk-in closet, and private gardens. Located near The Lakehall's entrance, brides can conveniently enter the suite for touch-ups or dress changes without being seen by their guests. The suite can be booked for overnight stays, which come with a free breakfast.



The Deck



The Terrace



THE OUTDOOR SPACES

Located closest to the lake, **The Deck** is an oval-shaped, outdoor theater with tiered seating. It is a place where guests can relax and bask in the outdoors, while enjoying some food and refreshments. It can fit around 300 guests and be used to hold talks, conduct wedding ceremonies, or stage musical performances.

The Terrace is a chic, outdoor lanai where guests can lounge and enjoy drinks while enjoying the lake and garden views. The space can fit 40 seated guests and is perfect for private dinners and intimate gatherings.

Lakehall

AT



+63 998 964 3181

inquiry@nenasanctuary.com

● www.facebook.com/nenasanctuary/

● [nenasanctuary](https://www.nenasanctuary.com)

[nenasanctuary.com](https://www.nenasanctuary.com)